

REVISIONS			
No.	By	Date	Description

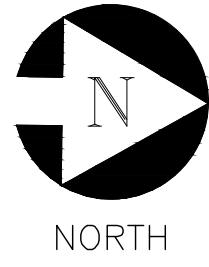

NORTH

SHINGISS STREET

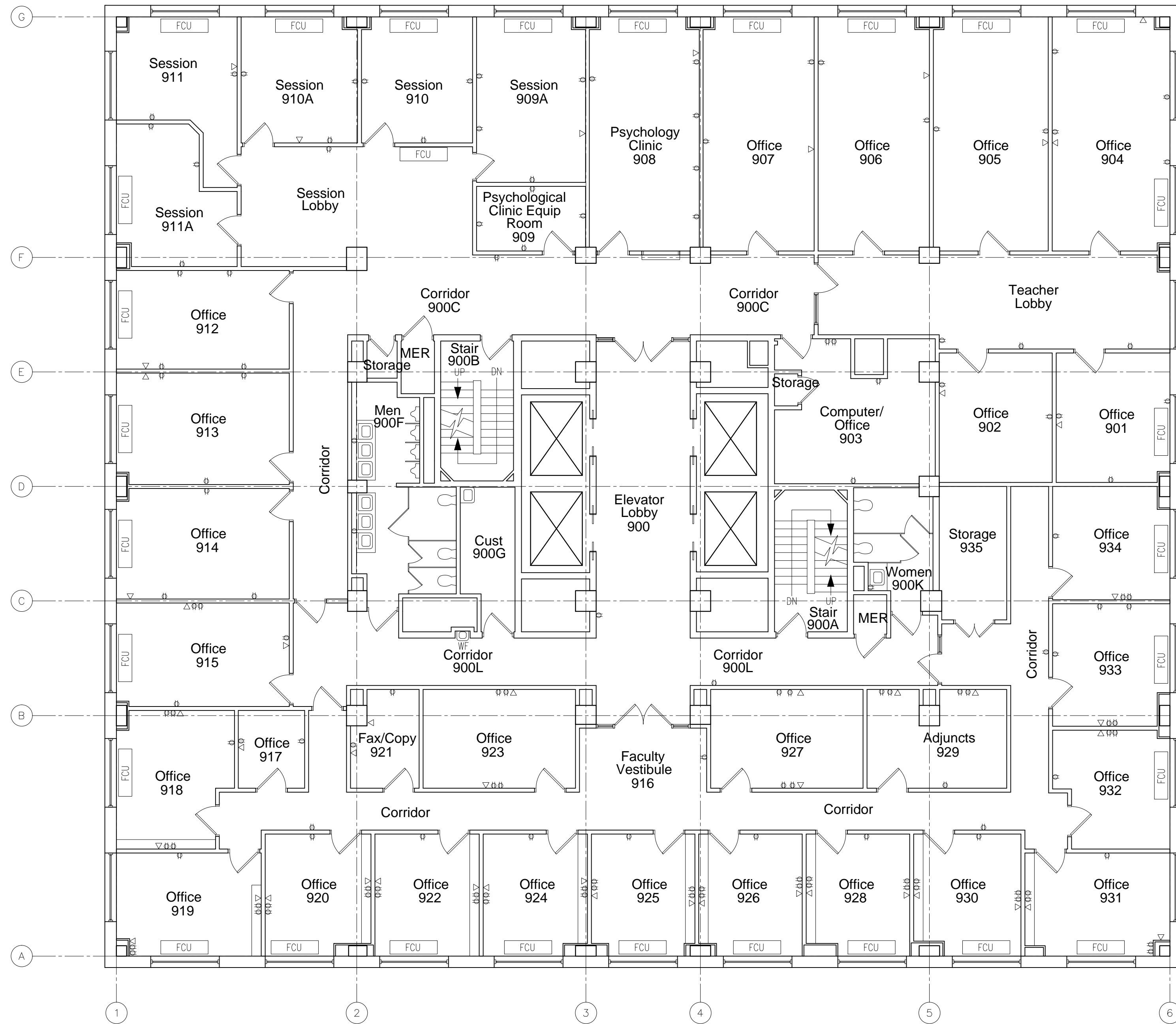

BOYD STREET

**NINTH FLOOR PLAN**

SCALE: 1/8" = 1'-0"



Gross Square feet = 11,529

THIS DRAWING IS INTENDED FOR INFORMATION PURPOSES ONLY. DUQUESNE UNIVERSITY IS NOT RESPONSIBLE FOR THE ACCURACY OF THIS DOCUMENT. ALL ROOM NUMBERS SHOWN ARE AS ASSIGNED BY THE UNIVERSITY AND MAY NOT MATCH CONTRACT DOCUMENTS. ALL DESIGN CONSULTANTS AND CONTRACTORS SHALL VERIFY DIMENSIONS AND EXISTING CONDITIONS ON SITE.



Project Name			
BUILDING RECORD DRAWING			
Drawing Description			
EXISTING CONDITIONS ROCKWELL HALL NINTH FLOOR PLAN			
CAD File Name			
rh-9.dwg			
Scale	Drawn By	Issue Date	Revision Date
AS SHOWN	ISM	12/9/10	.
Drawing Number	Set Order		
A12	12 of 14		